

# 1790 Rim touchbar device

The 1790 rim device is typically used in applications where maintenance is a concern because the rim device has fewer parts and pieces than current exit devices. The result is less maintenance and adjustment. The streamlined design has no openings for chains, reducing the risk for code infringements and offering increased building security by eliminating the possibility of tampering and forced entry through the use of coat hangers and other tools. The 1790 may also be used to retrofit a 2090 series crossbar device.



Length	Minimum door size (non-EL)	Minimum door size (EL)
30"	24"	28 1/2"
36"	30"	34 1/2"
42"	36"	40 1/2"
48"	42"	46 1/2"

- Lock/unlock capability
- ADA accessible
- Lever designs
  - Dane
  - Sutro
  - Quantum

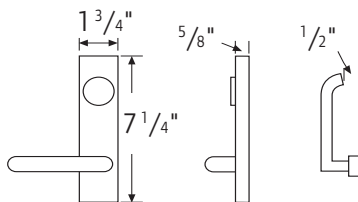

Lever projection: Quantum = 3"  
 Sutro = 2 7/8"  
 Dane = 2 7/8"

Key locks or unlocks trim. Lever retracts latchbolt when trim is unlocked. Dane, Quantum and Sutro levers return to within 1/2" of door.

## Specifications

Hand:	Non handed.
Functions:	See trim selection chart on this page.
Finishes:	US28, DC13, DC35, US3, US10, US26, US26D. Centercase and end cap are powder-coated black only.
Strikes:	TD35 strike supplied standard, see page 11 for other rim strikes available.
Latchbolt:	1" thickness, 3/4" throw.
Dogging feature:	Hex key dogging standard, except EL where must use hold back feature on outside cylinder.
Cylinder:	Rim night latch (NL) or hold back (HB) available (field selectable).
Sizes:	30", 36", 42", and 48".
Doors:	1 3/4" thick metal or wood, specify if wood door.**
Projections:	3 3/8" in neutral position, 2 3/8" in dogged position. Pushbar height is 2 1/2".
Stile:	1 3/4" minimum.
Electric functions:	EL - electric latch retraction, ED - electric dogging (both EL and ED require PS914-2RS minimum power supply). RX - request to exit switch, monitors pushpad SPTD switch.
Fasteners:	All machine screw mounting. Device mounting fasteners are concealed, latch fasteners are exposed to egress side.
End caps:	Black powder-coated metal end caps.
ANSI:	Carry UL label and approved for life safety. Certified ANSI A156.3 grade 1 standards.
Mullions:	Removable mullions are available for pairs of doors, see page 19.

Model	Trim package	Type	Function
1790	No outside trim	4	01
1791	Pull only (9970)	4	02
1792	Cylinder only	4	03/04* or 08/09*
1794	Pull (9970) and cylinder	4	02/03/04

\* Requires use of 179L

\*\* 9970 is for use on HM and Alum doors only. Not for use on wood doors.